

APPENDIX B: West Willoughby A153, Willoughby Road – proposed 40mph speed limit

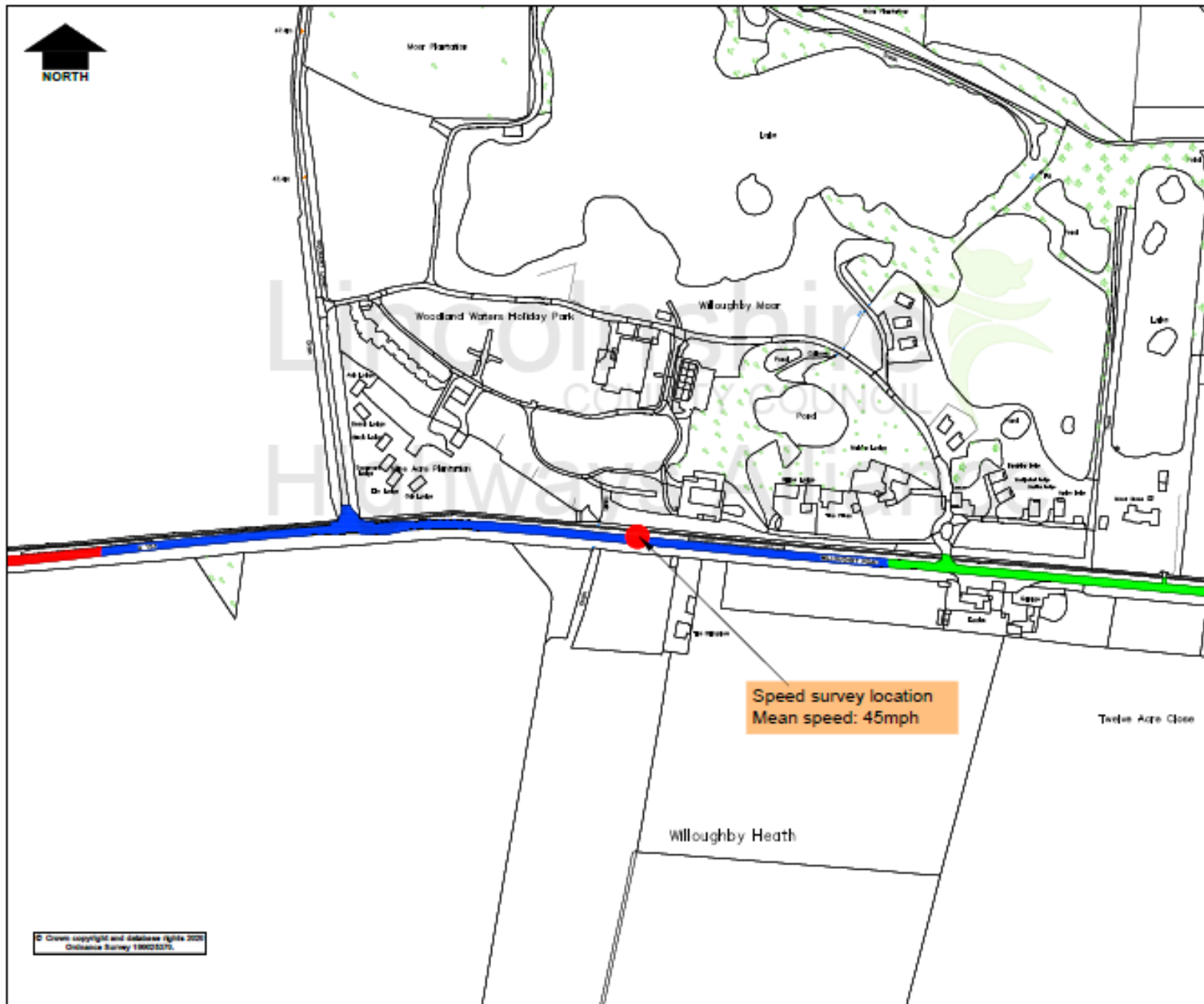

- Key:**
- Existing 50mph Speed Limit
  - Proposed 40mph Speed Limit
  - Existing 40mph Speed Limit

Rev	Description	Drawn	Checked	Auth	Date
1	A153 - West Willoughby				
002	Proposed 40mph Speed Limit				
NTS	LS				Nov 2022
TRO/LS/002/001					0

**Lincolnshire**  
COUNTY COUNCIL

**Highways Alliance**

Lincolnshire House, 26 Orchard Street, Lincoln, LN1 30X

© Crown copyright and database rights 2020  
Ordnance Survey 10005376

This page is intentionally left blank